

Domekt R 700 V C6M

Maximal air flow, m ³ /h	782
Maximal air flow, l/s	217
Reference flow rate, m ³ /s	0,149
Reference pressure difference, Pa	50
SPI, W/(m ³ /h)	0,26
Thermal efficiency of heat recovery, %	84
Electric air heater capacity, kW / Δt, °C	2/10,8
Supply voltage, V	1~230
Maximal operating current HE, A	11,6
Electric power input of the fan drive at maximum flow rate, W	181
Electric power input of the fan drive at reference flow rate, W	76
Filters dimensions BxHxL, mm	540x260x46
Unit dimensions BxHxL, mm	637x950x1070
Maintenance space, mm	1070
Unit weight, kg	110

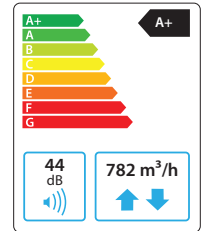

Acoustic data

A-weighted sound power level L_{WA} , dB(A) at reference flow rate

Supply inlet	55
Supply outlet	64
Exhaust inlet	55
Exhaust outlet	64
Casing	44

A-weighted sound pressure level L_{PA} , dB(A)

10 m² normally isolated room, distance from casing – 3 m.

Surroundings	33
--------------	----

Performance

Unit with standard equipment

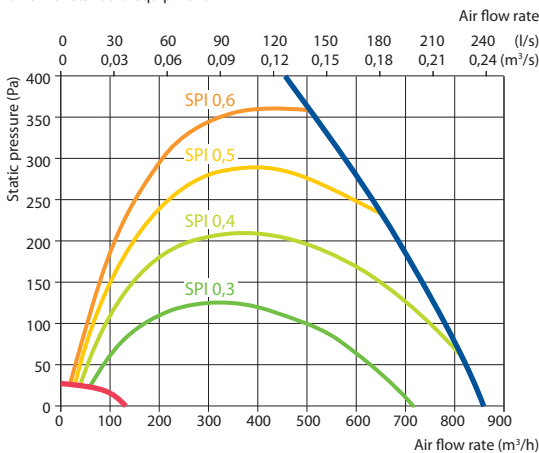

Temperature efficiency

	Winter					Summer		
Outdoor temperature, °C	-23	-15	-10	-5	0	25	30	35
After heat exchanger, °C	14,7	16,0	16,8	17,6	18,4	22,5	23,3	24,1

indoor +22°C, 20 % RH

Shown as left (L1)

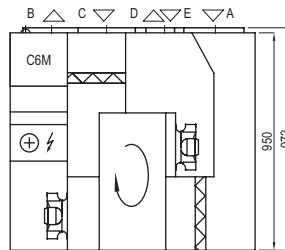

Shown as right (R1)

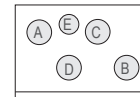

- A outdoor intake
- B supply air
- C extract indoor
- D exhaust air
- E additional extraction connection (by-pass – extraction without heat recovery)

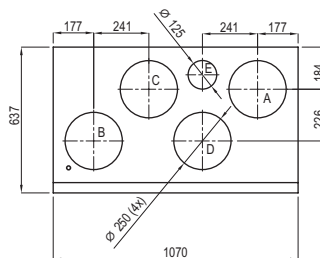

Accessories

Closing damper	AGUJ-M-250+LF230/CM230
Silencer	A/D AGS-250-50-600-M
	B/C AGS-250-50-900-M
Water heater	DH-250
PPU	PPU-HW-3R-15-0,63-W2
2-way valve (heater)	VVP47.10-0,63

Water cooler	DCW-0,7-5
2-way valve (cooler)	VVP47.15-2,5
Outdoor grill	LD-250
Water heater-cooler	DHCW-250
DX heater-cooler	DCF-0,7-5
Heat pump unit	MOU-18HFN8+KA8140

